

GENERAL NOTES

1. G.C. TO FIELD VERIFY ALL CONDITIONS & DIMENSIONS.
2. ALL DIMENSIONS ARE FROM FINISHED SURFACE OR FACE OF FINISHED SURFACE TO FINISHED SURFACE UNLESS NOTED OTHERWISE.
3. SEE CIVIL, STRUCTURAL, LANDSCAPING, ELECTRICAL, PLUMBING AND MECHANICAL SHEETS FOR ADDITIONAL SITE INFORMATION.
4. CANOPY CONTRACTOR TO COORDINATE CANOPY INSTALLATION OF CANOPY GUTTERS, DOWNSPOUTS, LIGHTING, POWER, DATA, MONITORS, TICKET VENDING, ETC.) LOCATIONS WITH SITE UTILITIES, CIVIL, PLUMBING, & ELECTRICAL CONTRACTORS.
5. COORDINATE WEST ISLAND & NORTH ENTRY CANOPIES WITH BUILDING FACADE STONE PANEL FABRICATION / INSTALLATION.



SPRINGFIELD SANGAMON
COUNTY TRANSPORTATION
CENTER
200 S. 9th Street, Springfield, IL

SEAL

D	10/04/21	IFC REV 1
C	7/22/21	IFC
B	7/12/21	ADDENDUM #2
A	6/18/21	BID
MARK	DATE	DESCRIPTION

ISSUE:	10/04/21
PROJECT NO:	19L0116A
DESIGN BY:	BF
DRAWN BY:	JN
REVIEWED BY:	BF / RS

SHEET TITLE
CANOPY DETAILS

ISSUED FOR
CONSTRUCTION
REV 1

A-TC-002

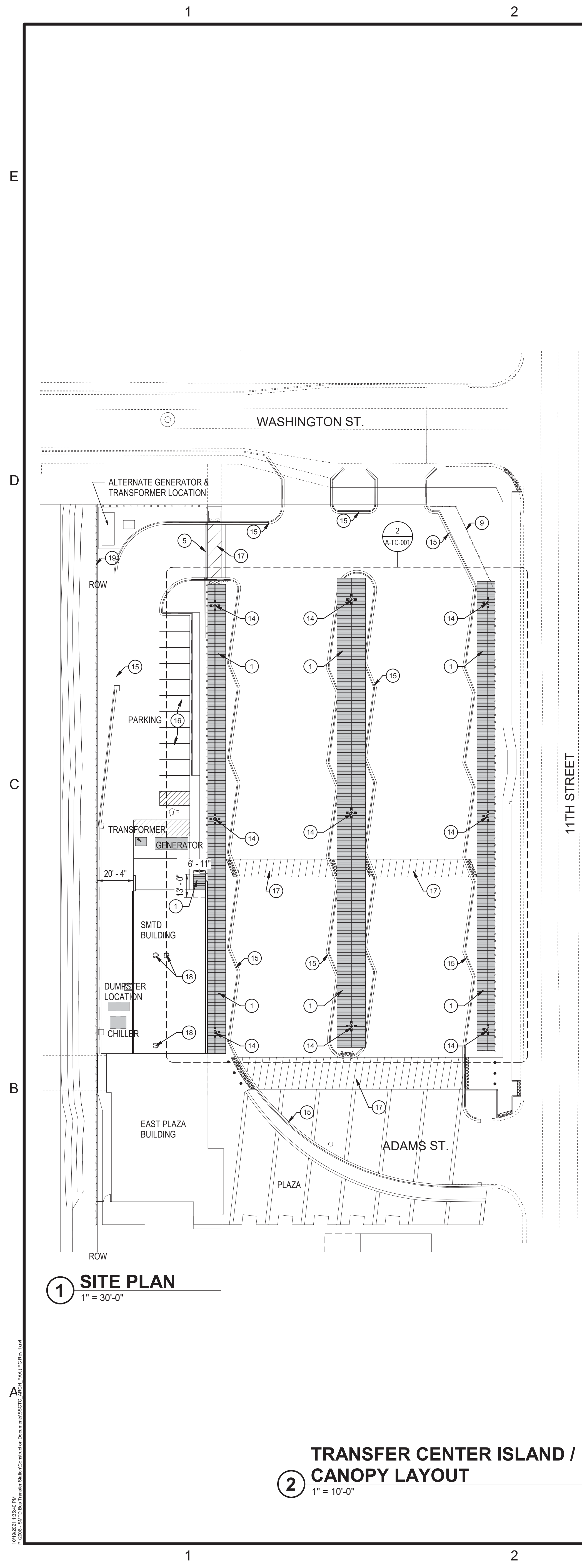

1 SITE PLAN
1" = 30'-0"

2 TRANSFER CENTER ISLAND / CANOPY LAYOUT
1" = 10'-0"

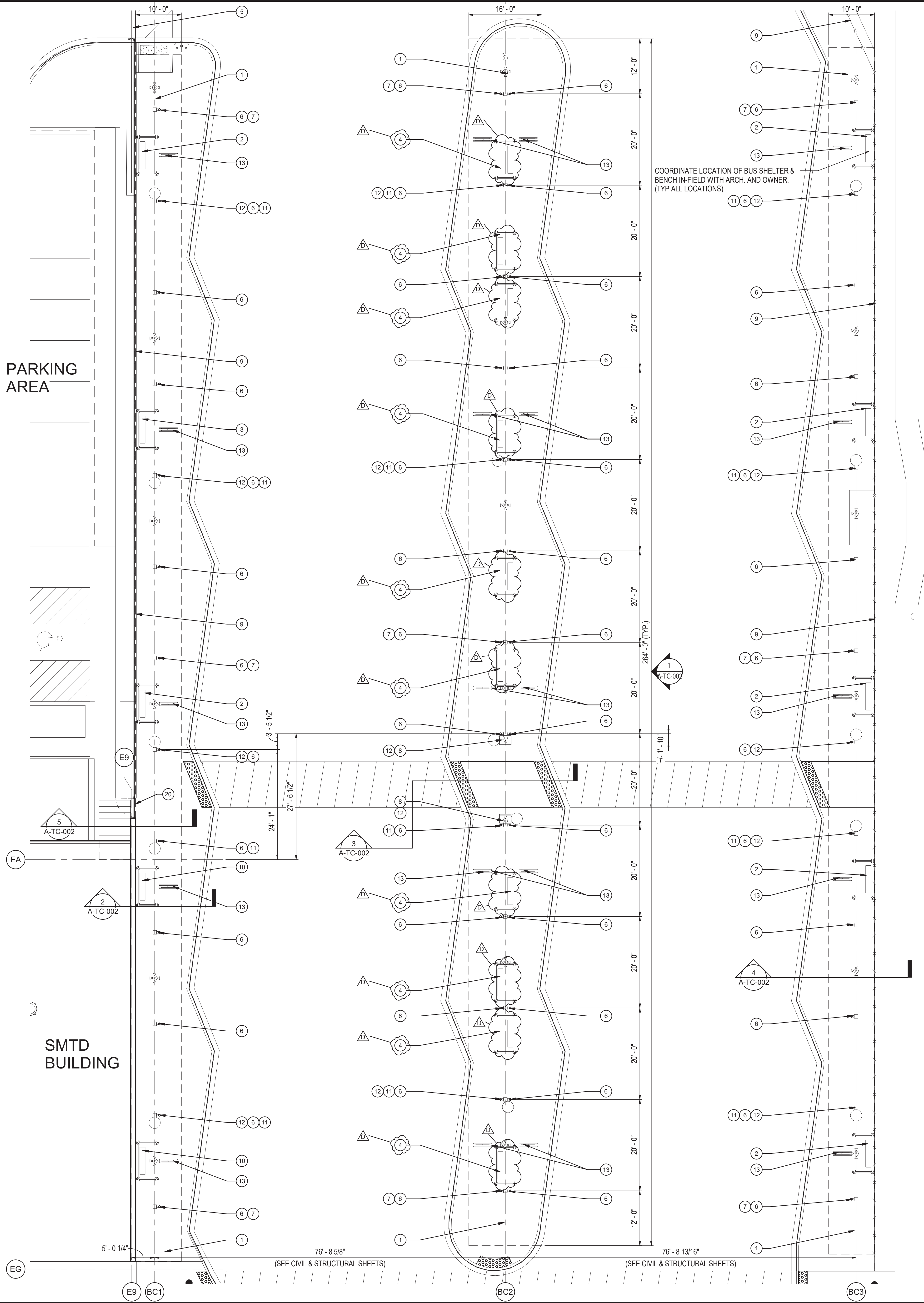

GENERAL NOTES

1. G.C. TO FIELD VERIFY ALL CONDITIONS & DIMENSIONS.
2. ALL DIMENSIONS ARE FROM FINISHED SURFACE OR FACE OF FINISHED SURFACE TO FINISHED SURFACE UNLESS NOTED OTHERWISE.
3. SEE CIVIL, STRUCTURAL, LANDSCAPE, ELECTRICAL, PLUMBING AND MECHANICAL SHEETS FOR ADDITIONAL SITE INFORMATION.

KEYED NOTES

- 1 PRE-FINISHED PAINTED STEEL CANOPY WITH INTEGRAL GUTTER & DOWNSPOUT WITH PRE-FINISHED STANDING SEAM ROOF PANELS. CONTRACTOR TO PROVIDE 3" PVC SCHEDULE 40 DOWNSPOUT, CLEAN-OUT, LEADER/ELBOW, WITHIN THE COLUMN TO TIE CANOPY INTEGRAL GUTTER TO UNDERGROUND STORM PIPING.
- 2 EXISTING SALVAGED 4'x8' BUS SHELTER AND BENCHES TO BE RE-INSTALLED BY CONTRACTOR.
- 3 PROVIDE 4'x8' BUS SHELTER & BENCH AS SPECIFIED. (MATCH EXISTING)
- 4 PROVIDE 4'x8' BUS SHELTERS & BENCH AS SPECIFIED. (MATCH EXISTING)
- 5 6'x30' AUTOMATED ROLLING SECURITY GATE. SEE CIVIL AND LANDSCAPE SHEETS.
- 6 CANOPY LIGHTING AT COLUMN. SEE ELECTRICAL SHEETS.
- 7 SITE LIGHTING ON 27'-0" COLUMN. SEE ELECTRICAL SHEETS.
- 8 TICKET VENDING MACHINE (PROVIDED BY OWNER). SEE ELECTRICAL SHEETS FOR CONTRACTOR PROVIDED ELECTRICAL / DATA.
- 9 SITE FENCING. SEE LANDSCAPE AND CIVIL SHEETS.
- 10 PROVIDE 4'x8' 3-SIDED BUS SHELTER (WITHOUT ROOF) & BENCH AS SPECIFIED. (MATCH EXISTING)
- 11 PROVIDE FIBER AT 8'-8" AND POWER AT 8'-0" ON CANOPY COLUMN. SEE ELECTRICAL.
- 12 TRASH RECEPTACLES. SEE LANDSCAPE SHEETS. CONFIRM LOCATIONS WITH SMTD.
- 13 OWNER TO PROVIDE AND INSTALL MONITORS AND MONITOR BRACKETS IN LOCATIONS SHOWN. GC TO PROVIDE POWER & DATA TO MONITOR LOCATIONS. GC TO COORDINATE WITH CANOPY MFR. AND ELEC. CONTRACTOR.
- 14 SITE LIGHTING. SEE ELECTRICAL SHEETS.
- 15 CURB AND GUTTER. SEE CIVIL SHEETS
- 16 PARKING. SEE CIVIL SHEETS
- 17 STRIPED CROSS WALK. SEE CIVIL SHEETS.
- 18 ROOF TOP EXHAUST FAN.
- 19 FENCE, BY OTHERS.
- 20 PEDESTRIAN GATE. 4'x6'. SEE LANDSCAPE SHEETS AND DOOR & FRAME SCHEDULE

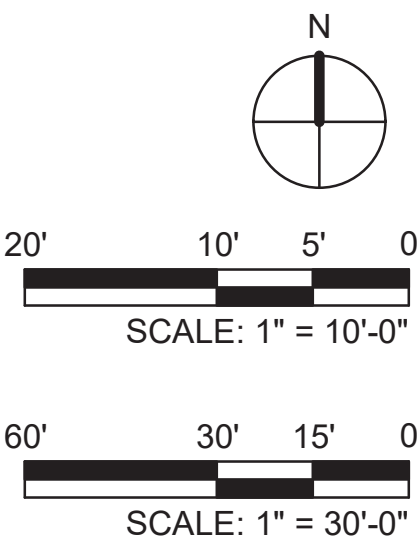

SPRINGFIELD SANGAMON
COUNTY TRANSPORTATION
CENTER
200 S. 9th Street, Springfield, IL

SEAL

MARK	DATE	DESCRIPTION
D	10/04/21	IFC REV 1
C	7/22/21	IFC
B	7/12/21	ADDENDUM #2
A	6/18/21	BID

ISSUE: 10/04/21
PROJECT NO: 19L0116A
DESIGN BY: BF
DRAWN BY: JN
REVIEWED BY: BF / RS

SHEET TITLE
TRANSFER CENTER
ISLAND / CANOPY
LAYOUT

ISSUED FOR
CONSTRUCTION
REV 1

A-TC-001